

656028, House, 3D



1. Die-cut and fold on all crease lines.



2. Fold locking tabs on roof and insert them into the slots on the opposite roof side. Unfold the locking tabs to hold them in place. It is a good idea to place a piece of tape over each tab to keep them from snagging as the House opens up.

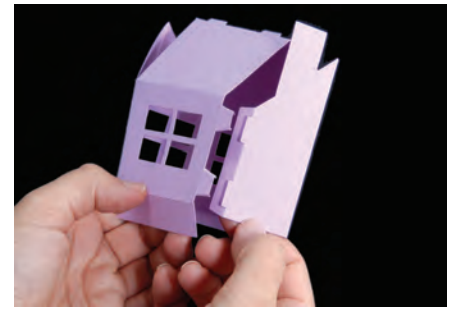

3. Fold the locking tabs on the window side and insert them into the slots on the chimney side. Unfold the tabs to hold them in place.

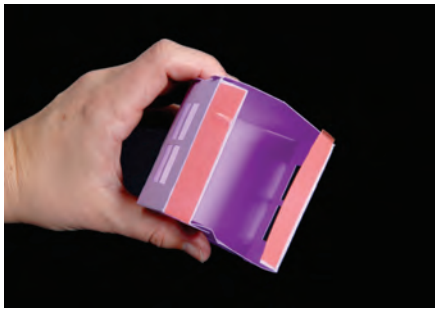

4. Add double-sided tape to bottom tabs.

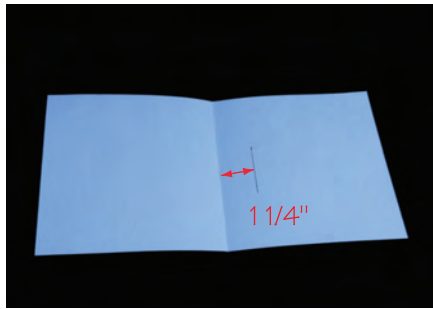

5. On the card, draw a light pencil line 1 1/4" to the right of the center fold. (Note: Minimum card size to conceal the House is 5" x 5 1/2".)

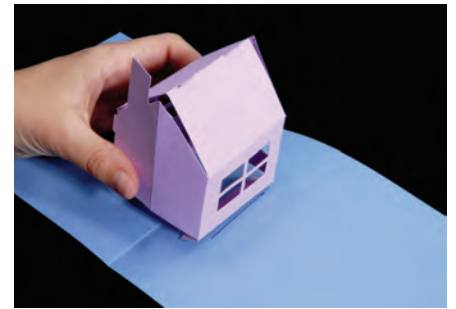

6. Align the side of the House with the pencil line and adhere it to the card.

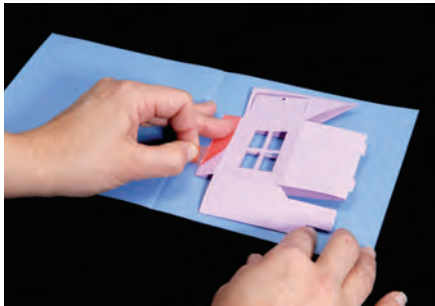

7. Lay the House flat and remove adhesive film.

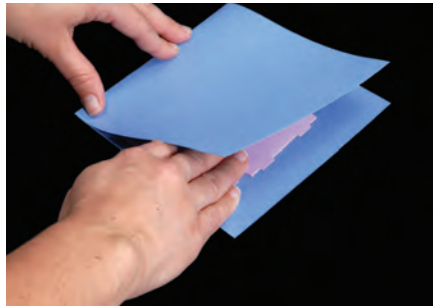

8. Continue to hold the House flat as you close the card and come in contact with the adhesive strip.



9. House and card are ready to embellish.